

Applies To: 2000-02 S2000 – ALL

October 2, 2001

2000-02 S2000: PDI and New Model Information

(Supersedes 99-078, 2000 S2000: PDI and New Model Information, dated April 18, 2000)

Many of the S2000 PDI procedures are the same as for any Honda vehicle, but some features need special attention. This service bulletin outlines the PDI procedures for these features as well as some new model information.

WARRANTY CLAIM INFORMATION

None; these procedures are considered part of PDI.

FUSES

The No. 54 (30 A) fuse (Backup/ACC) in the main under-hood fuse/relay box is removed during shipping and stored in the beverage holder. Make sure you reinstall this fuse.

No. 54 (30A) FUSE (BACKUP/ACC)

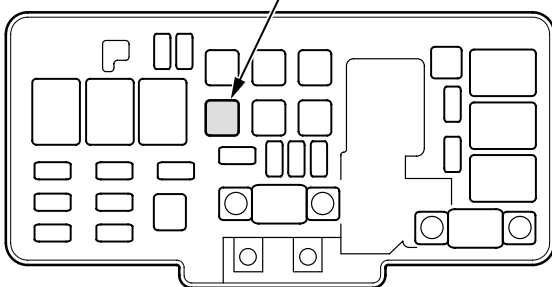

ACCUMULATED MILEAGE ON ODOMETER

Some vehicles may have up to 60 miles on the odometer at the time of delivery. This is due to factory testing to ensure high-quality vehicle production.

CONVERTIBLE TOP SHIPPING COVER REMOVAL

To prevent damage to the convertible top and to the rear window, follow these steps when removing the shipping cover:

1. Rinse the entire vehicle with water.
2. Peel off the tape from the windshield along the front edge of the shipping cover.

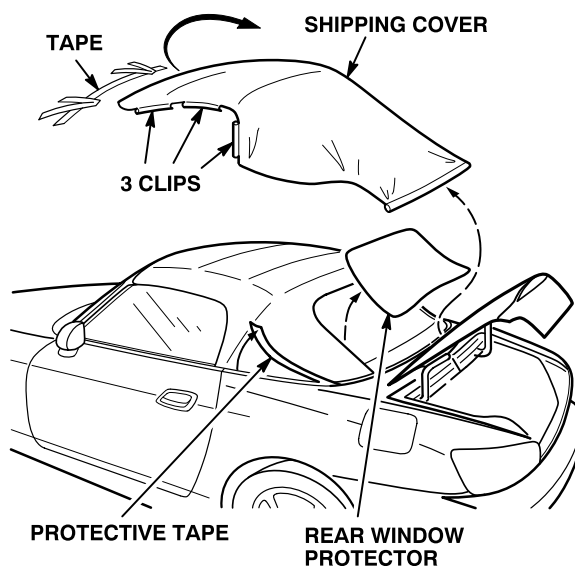

3. Release the three shipping cover clips in each window opening.
4. Pull back the shipping cover over the trunk.
5. Open the trunk, and remove the shipping cover from under the trunk lid.
6. Remove the shipping cover from the vehicle.
7. Remove the rear window protector sheet, and peel off the protective tape.
8. Peel off the Rapgard from the rest of the vehicle.

ANTENNA MAST

The antenna mast is shipped in the PDI plastic bag. Make sure the antenna mounting threads are clean, then screw it into the antenna mount in the rear quarter panel.

KEYLESS ENTRY AND OPTIONAL DEALER-INSTALLED SECURITY SYSTEMS

The S2000 has a factory-installed keyless entry system. An optional dealer-installed security system with keyless entry is also available. The remote transmitters for the keyless entry system and security system look similar, but they are *not* interchangeable.

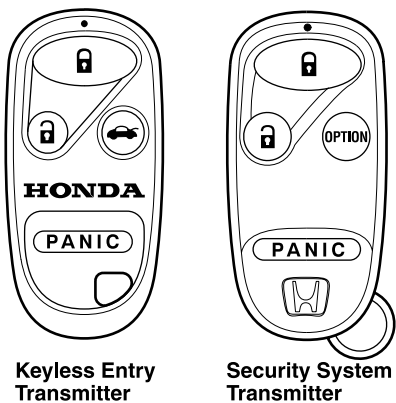

Two remote transmitters for the keyless entry system are stored in the upper console glove box during shipping. Make sure the transmitters lock and unlock both doors and open the trunk. The trunk release has a 2-second delay.

SPRING SPACERS

The S2000 is shipped with rubber spacers on the springs to lift the vehicle and prevent shipping damage. Make sure you remove the spring spacers before driving the vehicle over 12 mph or the vehicle could get damaged. To remove the spacers, raise the vehicle on a lift to extend the springs. Remove the five spacers from each of the front springs and the two spacers from each of the rear springs.

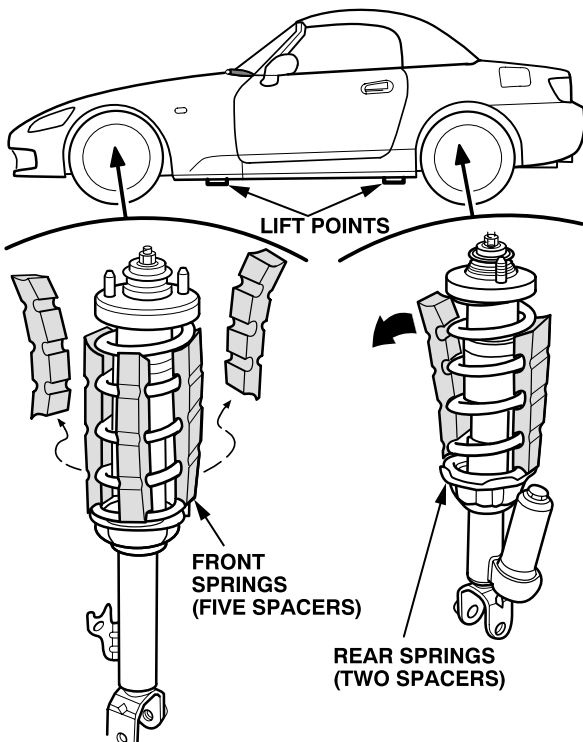

TIE-DOWN HOLE PLUGS

Four body plugs are included in the PDI plastic bag. Make sure you install them in the tie-down holes.

The front tie-down holes have two layers. Make sure you install the front plugs on the *inner* layer.

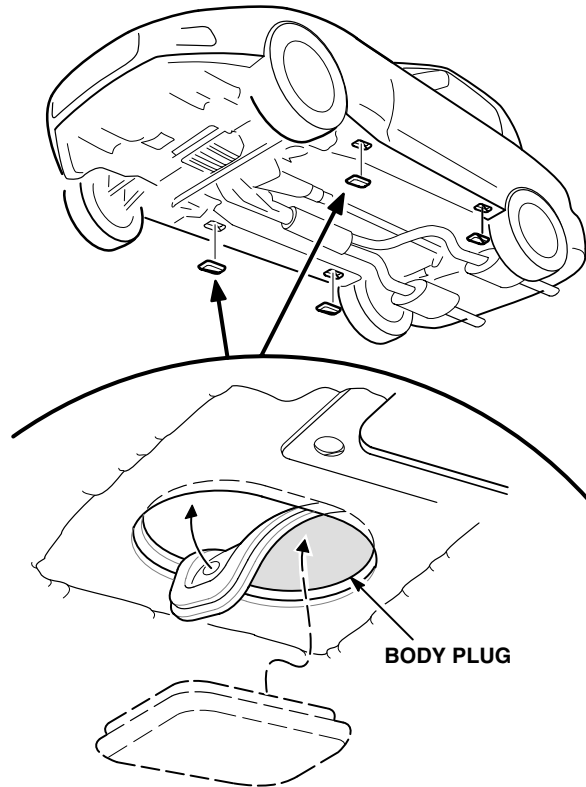

FRONT AND REAR STRAKES

Front and rear strakes and related hardware are included in the PDI plastic bag. Install the front strakes on both sides of the vehicle. Remove the rear wheels, and install both rear strakes.

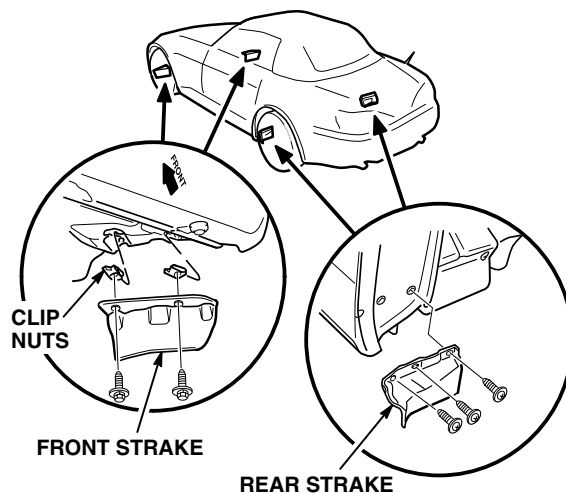

FUEL FILL DOOR RELEASE

To open the fuel fill door, pull the release knob on the driver's door jamb.

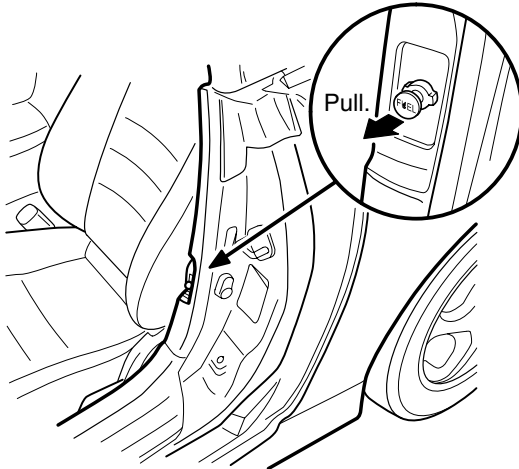

WASHING THE S2000

Do not use an automatic car wash or high-pressure washer on an S2000. Water may leak into the interior, damage the convertible top, or both.

CONVERTIBLE TOP OPERATION

To lower the convertible top, do this:

1. Set the parking brake. The convertible top will *not* work unless the parking brake is fully engaged.
2. Turn the ignition switch to ON (II).
3. Push in the tabs on the two lock handles, and pull the handles down.

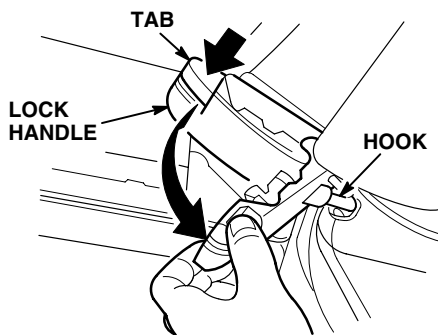

4. Push the convertible top forward while you release the hooks from the windshield header.

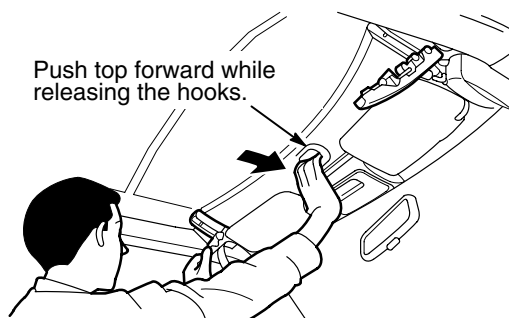

5. With the hooks released, push the lock handles up until they latch.

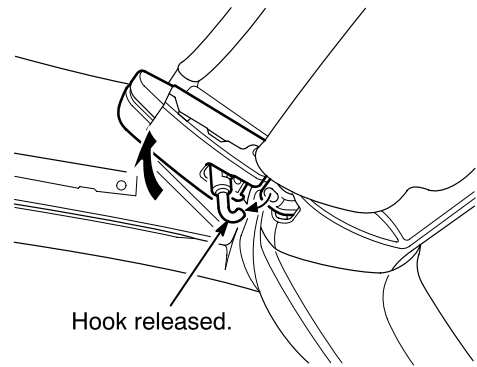

6. Pull back and hold the ROOF switch. Both windows start to lower and the convertible top folds back. Make sure the top goes all the way down.

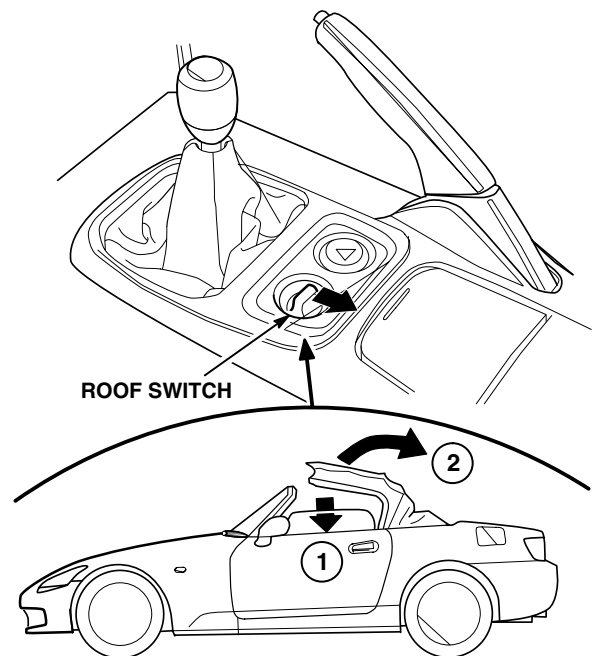

To raise the convertible top, do this:

1. Set the parking brake. The convertible top will *not* work unless the parking brake is fully engaged.
2. Turn the ignition switch to ON (II).
3. Push the ROOF switch forward and hold it. If the windows are raised, both windows start to lower, and the convertible top rises. Release the ROOF switch when the top reaches the windshield header.
4. Push in the tabs on the lock handles, and pull the handles down.
5. Push the tabs again to set the hooks into the windshield header. On 2002 models, because of the weight of the glass rear window, make sure you pull the roof all the way forward so the hooks can set.
6. Push the lock handles up until they latch.

STARTING THE ENGINE

Press the clutch pedal all the way down. Turn the ignition switch to ON (II). Press the ENGINE START button.

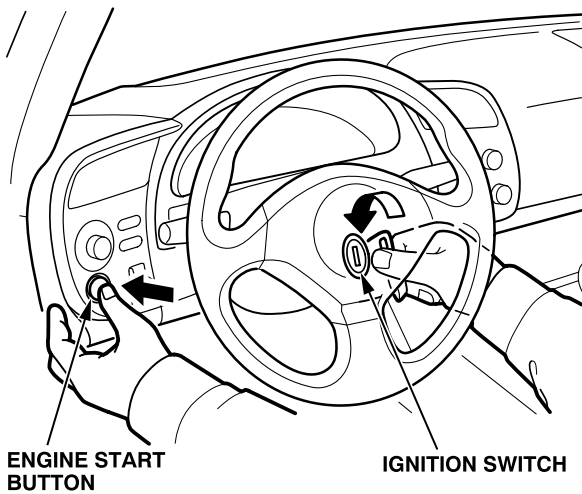

SHIFTING INTO REVERSE

The 6-speed manual transmission has a lockout feature so you cannot accidentally shift from 5th gear to Reverse instead of to 6th gear. Press the clutch pedal all the way down, move the shift lever to the Reverse side of the Neutral gate, then push the shift lever down, and shift into Reverse.

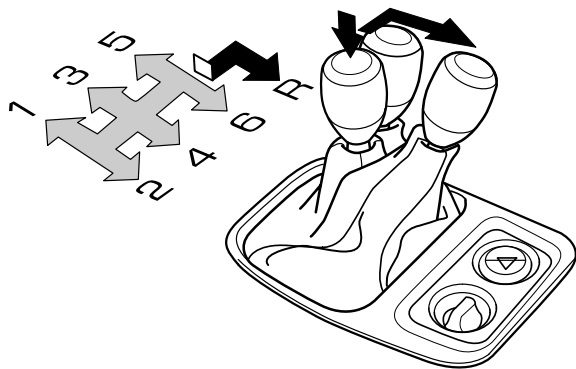

DUST AND POLLEN FILTER

The dust and pollen filter is under the right side of the cowl cover. To replace the filter, release the clips, and lift up the right side of the cowl cover.

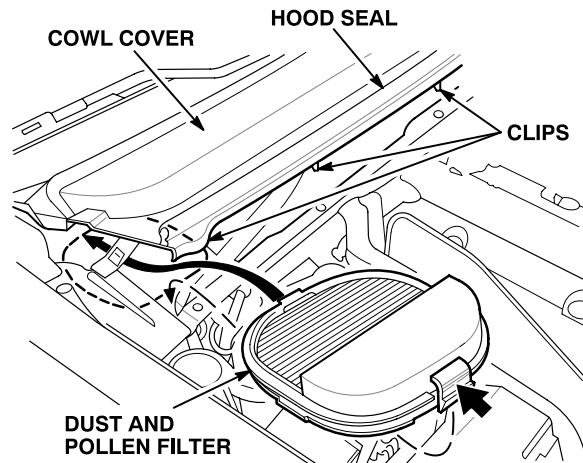

LIQUID CRYSTAL DISPLAY

The instrument panel brightness is controlled by the - and + buttons on the left side of the panel. Push the buttons to make sure there are five levels of brightness.

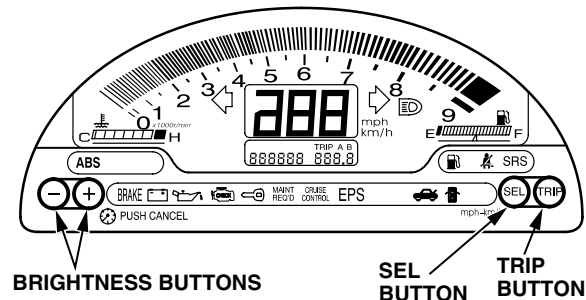

To switch the reading between MPH and KM/H, push the SEL button on the right side of the instrument panel, and hold it until you hear a beep.

To switch between Trip A and Trip B, push and release the TRIP button. To reset a trip meter, display it, then push and hold the TRIP button until you hear a beep and the number resets to 0.0.

The tachometer does *not* work properly when the interior temperature is -10° F or lower.

PLASTIC ROLL BAR COVERS

The integrated roll bar behind each seat has a plastic cover. Do *not* try to remove it; you will destroy the cover if you do. If you need to remove the plastic roll bar covers, unbolt the entire roll bar assembly from the body.

SPARE TIRE

Do *not* drive the S2000 with the compact spare tire mounted on the rear; it will damage the limited slip differential. Refer to the owner's manual for proper spare tire use.

TIRE ROTATION

Do *not* rotate the tires on an S2000; the rear tires are wider than the front tires and will *not* fit correctly. Since the tires are directional, they also *cannot* be rotated side-to-side.

WHEEL BALANCE AND ALIGNMENT

The wheels on an S2000 have no exterior flange to mount wheel weights or alignment equipment. You can, however, mount Honda alloy wheel weights on the inner side of the wheels; but they must be self-adhesive weights. See page 1-14 of the 2000-02 S2000 Service Manual. Mount alignment equipment on the outer lip of the wheels.

OILS AND FILTER

Engine Oil: API service, SJ, SAE viscosity 10W-30 or 5W-40.

Transmission Oil: Honda MTF.

Differential Oil: API GL5 gear oil, SAE viscosity 90.

Because of the high-revving nature of the S2000 engine, the oil filter torque is *very* important. Make sure you torque the filter to 22 N·m (16 lb-ft).

The engine oil dipstick has a black handle. The dipstick is on the left side of the valve cover.

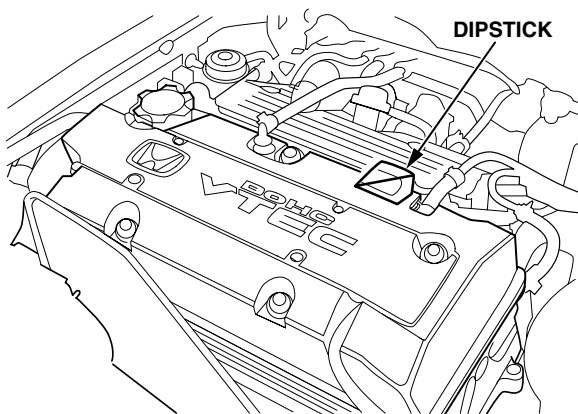

DIGITAL CLOCK SETTING

To set the time in the 2002 S2000, press and hold the CLOCK (SCAN RPT) button, then press the H (Preset 4) button to change the hour setting or the M (Preset 5) button to change the minute setting.

